



8588 KATY FREEWAY | SUITE 441
HOUSTON, TX 77063 | 713.463.8200

CONSULTANT TEAM:
LANDSCAPE ARCHITECT
KNUDSON LP
8588 KATY FREEWAY, STE. 441
HOUSTON, TX 77024

SURVEYOR
TOTAL SURVEYORS INC.
4301 CENTER STREET
DEER PARK, TX 77536

STRUCTURAL
PAUL ENGINEERING INC.
626 1/2 BARRINGER LN, SUITE A
WEBSTER, TX 77598

IRRIGATION
CPI IRRIGATION
31323 BEARING STAR
TOMBALL, TX 77375

ELECTRICAL
JORDAN & SKALA ENGINEERS
11231 RICHMOND AVE, SUITE, D104
HOUSTON, TX 77082

CIVIL
MIDTOWN ENGINEERS
5225 KATY FREEWAY, SUITE 400
HOUSTON, TX 77007

SEAL:



Bryan Paul Jambor
20 Aug 2014

PROJECT:
DEER PARK GATEWAY

CLIENT:
CITY OF DEER PARK
710 E. SAN AUGUSTINE
DEER PARK, TX 77536

PACKAGE:

| NO. | DATE: | DESCRIPTION: |
|-----|---------|---------------|
| 1 | 8/28/14 | ISSUE FOR BID |

| | |
|--------------------------------|------------|
| PROJECT NO: 13-16970 | DESIGN BY: |
| ISSUE DATE: AUGUST 28, 2014 | DRAWN BY: |

| | |
|--------------------|--------------|
| SCALE: AS NOTED | REVIEWED BY: |
|--------------------|--------------|

SHEET TITLE
LAYOUT PLAN

SHEET NUMBER

L2.1

PAVING LEGEND

| SYM | TYPE |
|-----|---|
| A | 4"x8" (60MM) CONCRETE UNIT PAVER, VERONA AS MFGR'D BY PAVESTONE. COLOR 'A' - TO BE SELECTED BY OWNER |
| B | 4"x8" (60MM) CONCRETE UNIT PAVER, VERONA AS MFGR'D BY PAVESTONE. COLOR 'B' - TO BE SELECTED BY OWNER |
| C | 4"x8" (60MM) CONCRETE UNIT PAVER, HOLLAND AS MFGR'D BY PAVESTONE. COLOR 'A' - TO BE SELECTED BY OWNER |
| D | 4"x8" (60MM) CONCRETE UNIT PAVER, HOLLAND AS MFGR'D BY PAVESTONE. COLOR 'B' - TO BE SELECTED BY OWNER |

Replacement of stone (205 sf total)
Type A - 90 sf
Type B - 115 sf

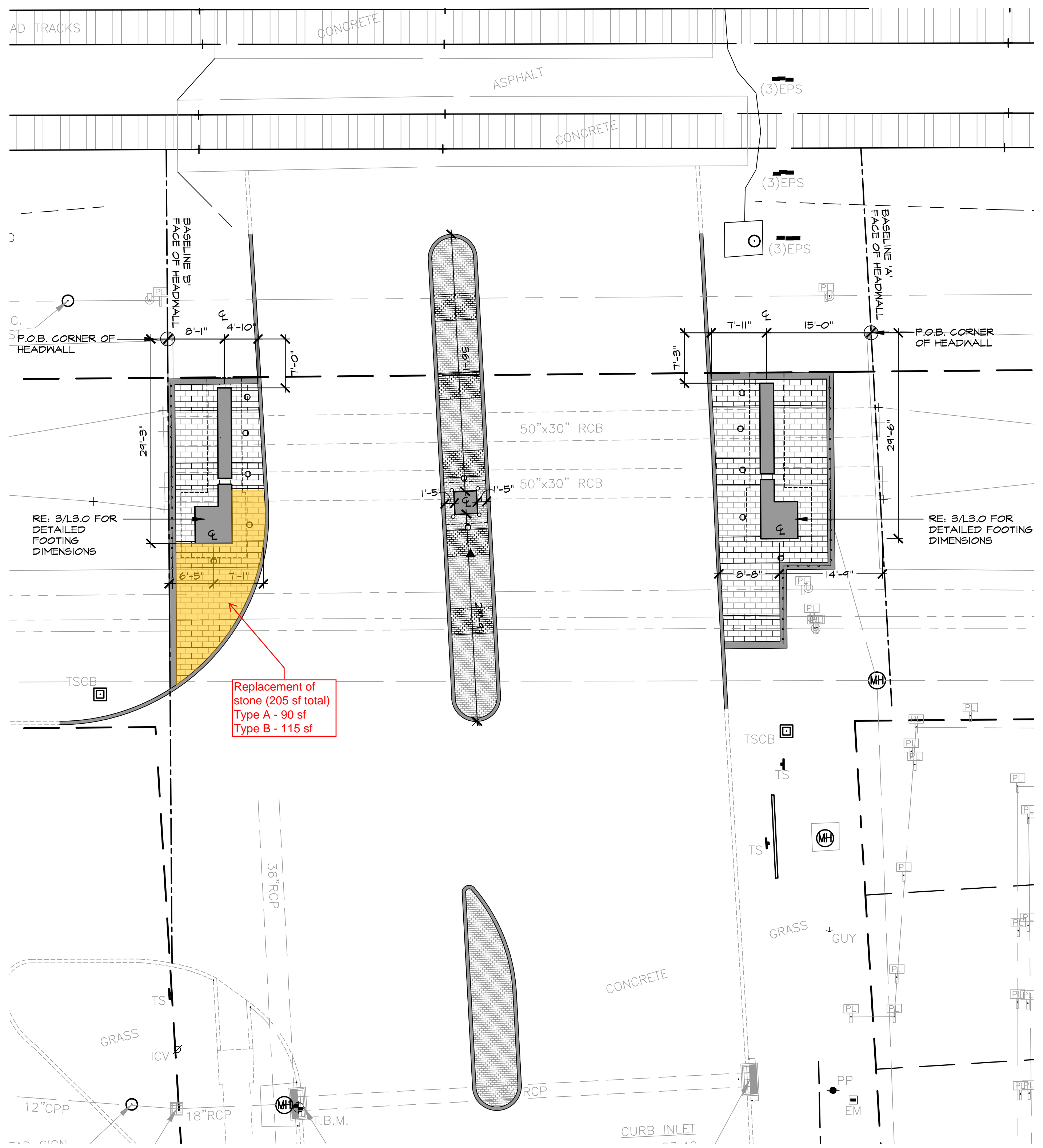

2 GATEWAY LAYOUT PLAN

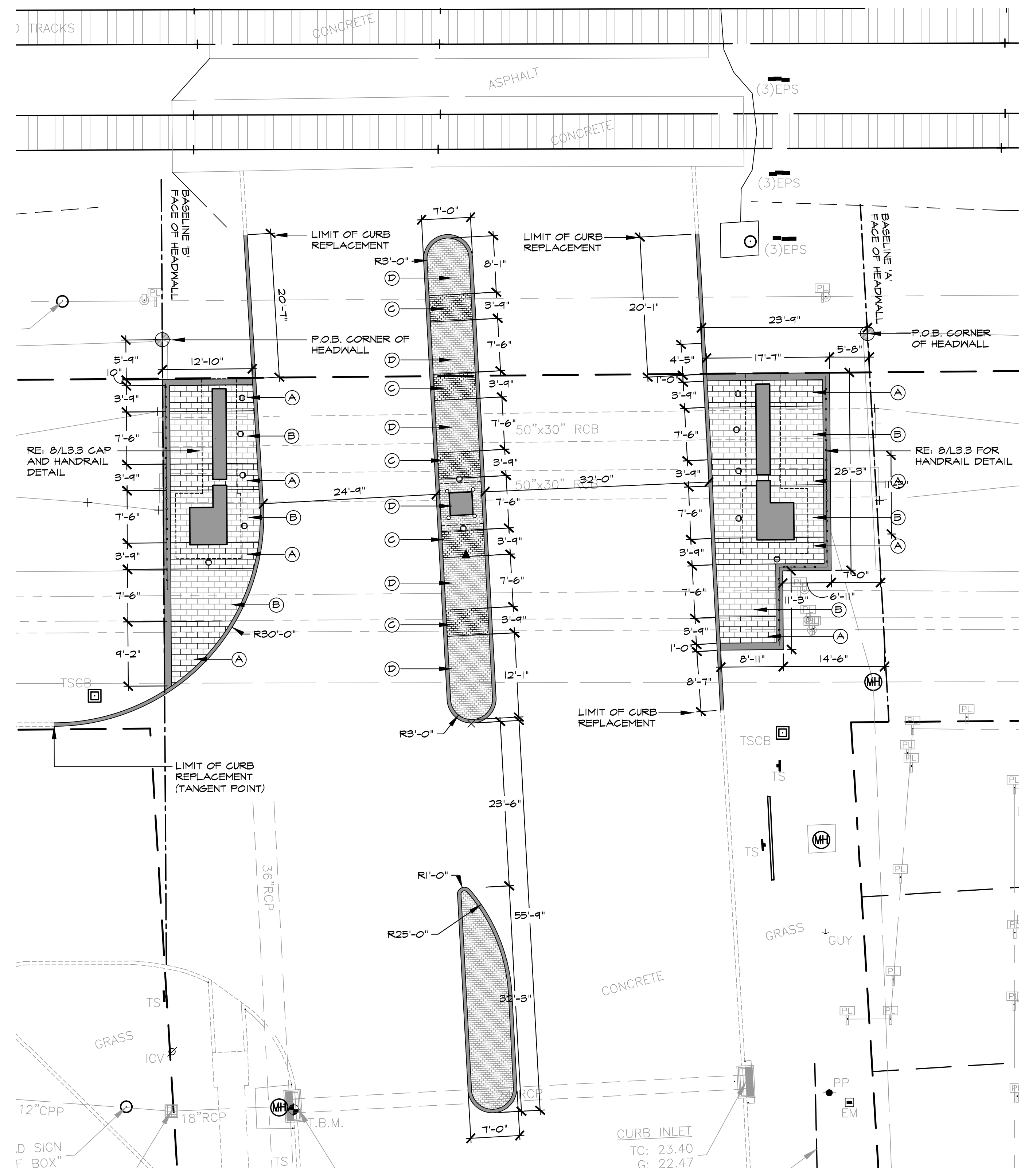
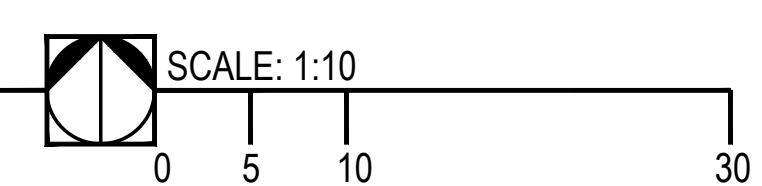

1 PAVING LAYOUT PLAN

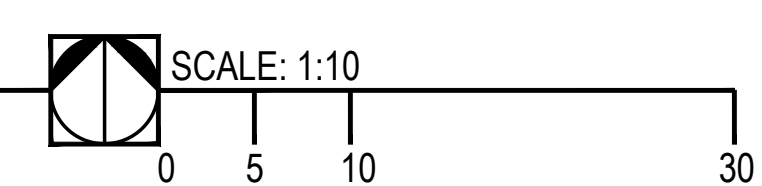

H:\Projects\13-16970 Deer Park Gateway\Graphics\514 Construction Documents\ISSUE FOR BID\L2.1_LAYOUT PLAN.dwg Plotted: Aug 28, 2014 - 4:11pm by b.jambor

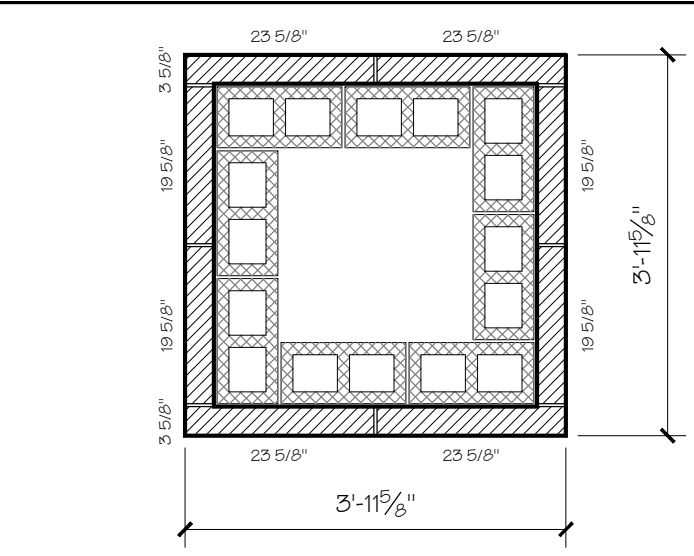

12 SECTION THRU COURSE PATTERN "E"
1/2" = 1'-0"

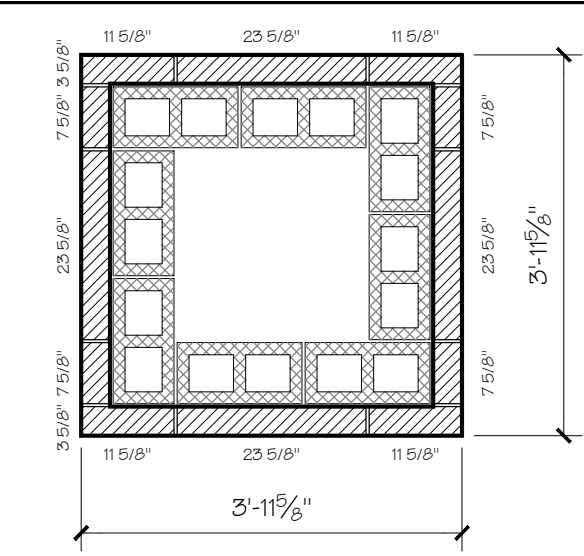

13 SECTION THRU COURSE PATTERN "F"
1/2" = 1'-0"

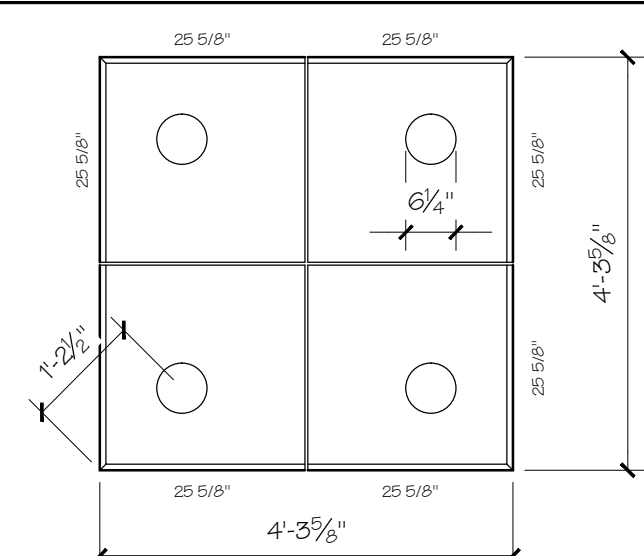

14 PLAN VIEW @ TOWER CAP
1/2" = 1'-0"

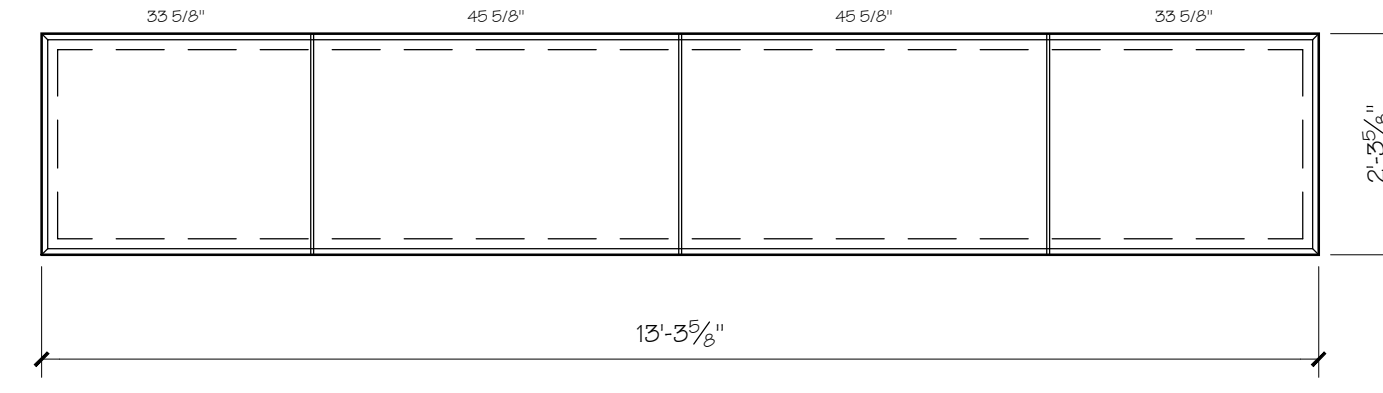

15 ELEVATION @ WALL
1/2" = 1'-0"

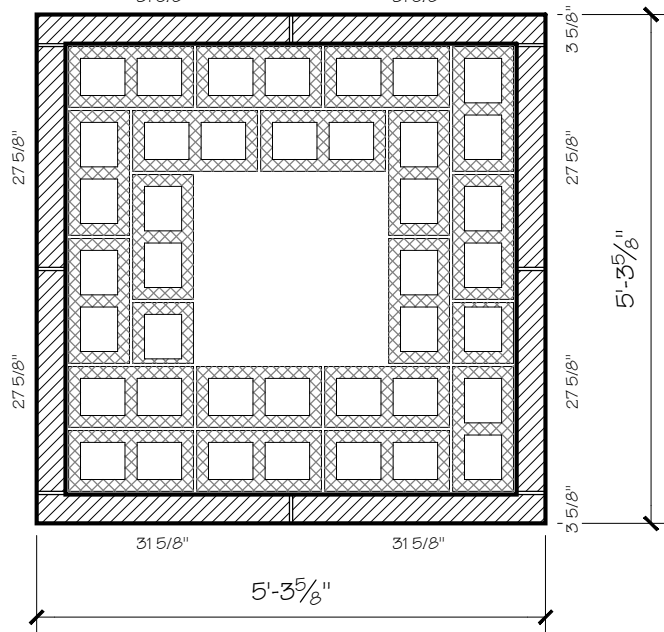

9 SECTION THRU COURSE PATTERN "C"
1/2" = 1'-0"

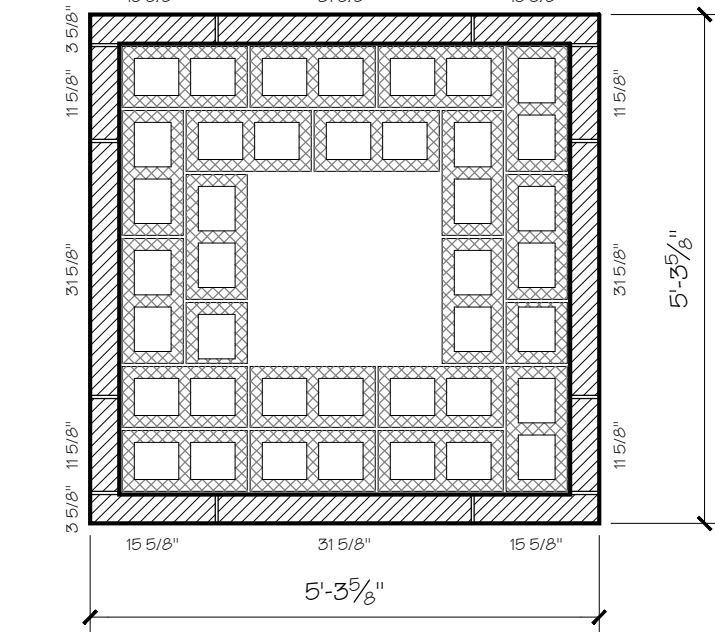

10 SECTION THRU COURSE PATTERN "D"
1/2" = 1'-0"

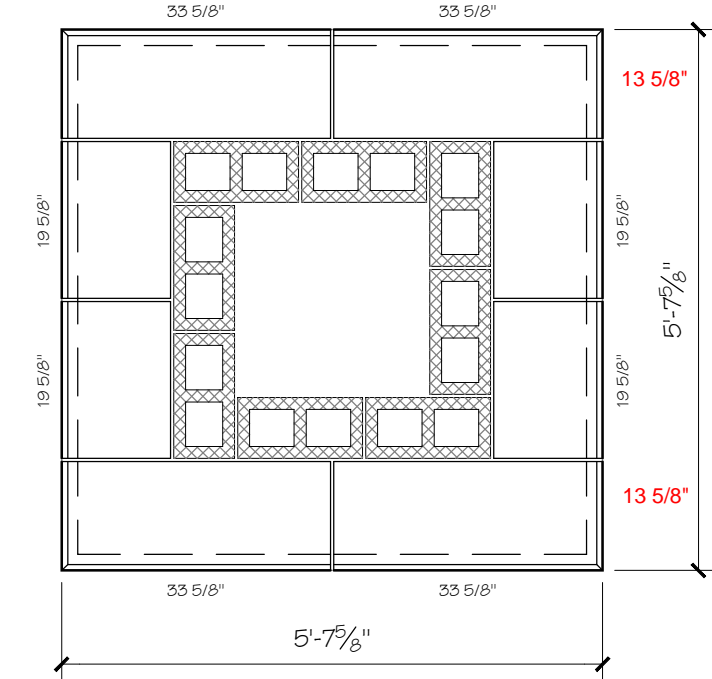

11 PLAN VIEW @ TOWER CAP
1/2" = 1'-0"

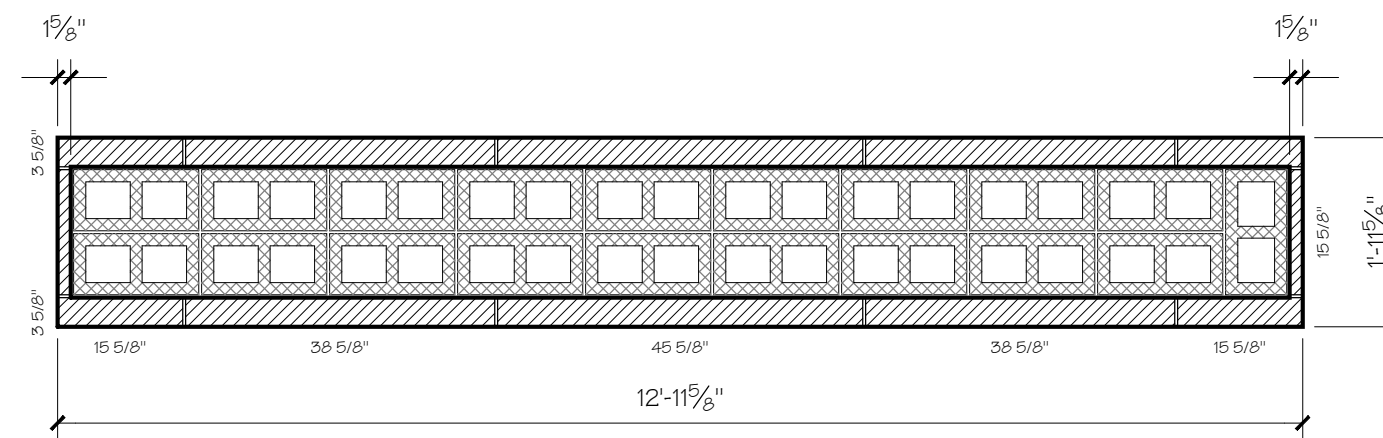

16 ELEVATION @ WALL
1/2" = 1'-0"

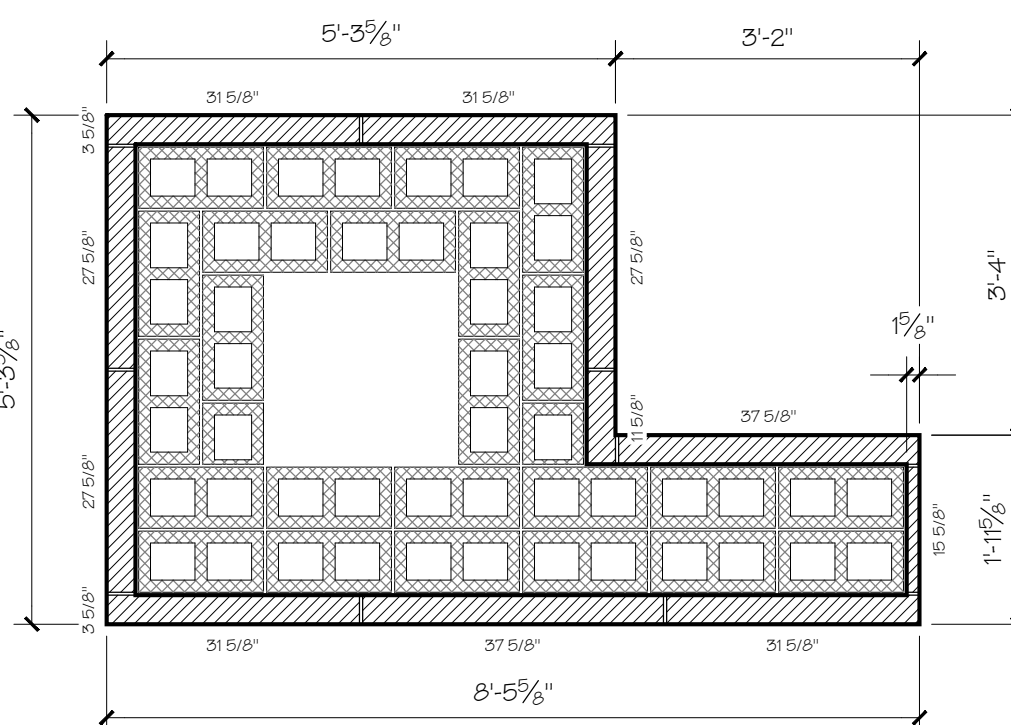

6 SECTION THRU COURSE PATTERN "A"
1/2" = 1'-0"

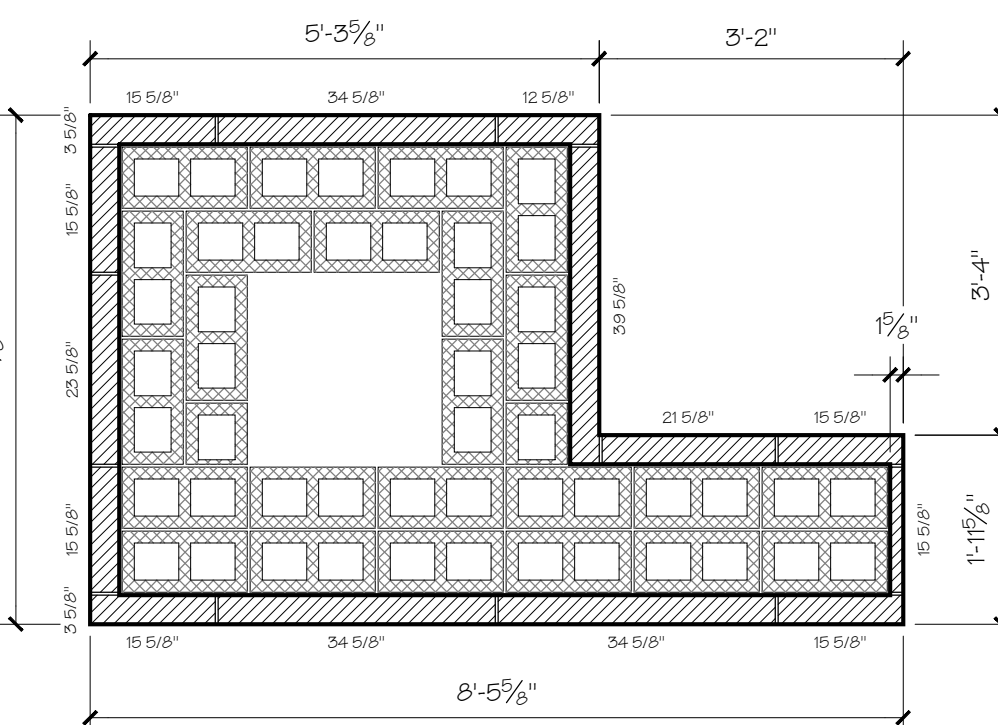

7 SECTION THRU COURSE PATTERN "B"
1/2" = 1'-0"

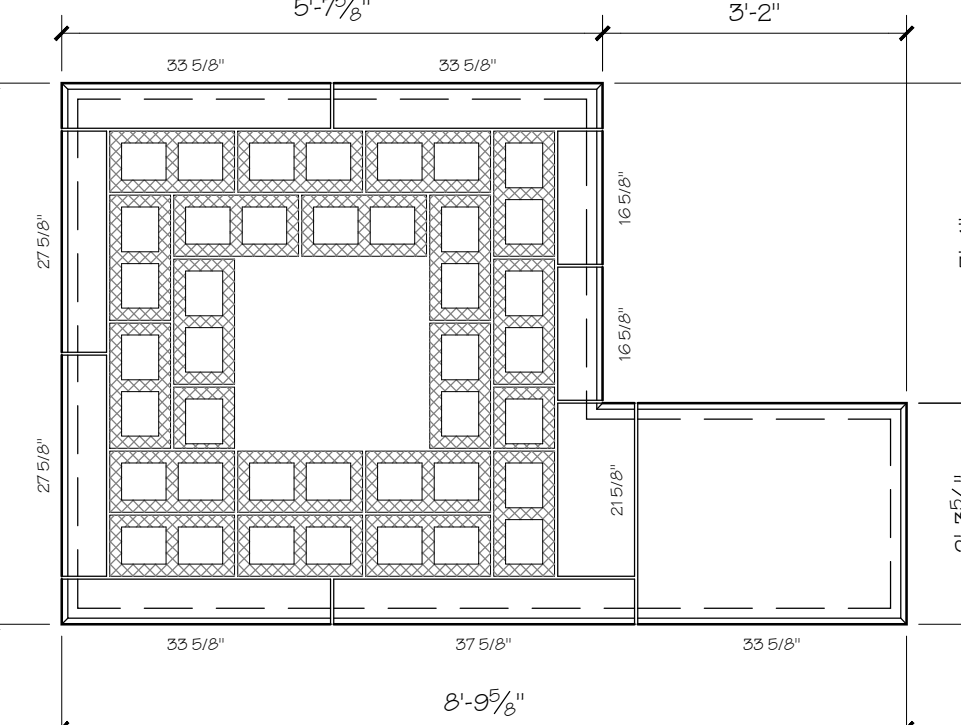

8 PLAN VIEW @ TOWER CAP
1/2" = 1'-0"

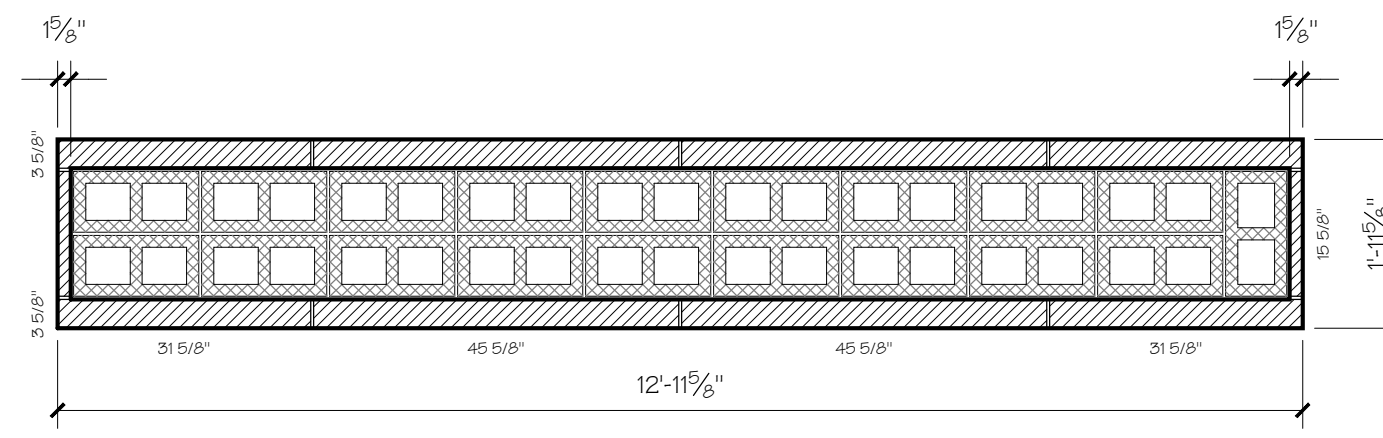

17 ELEVATION @ WALL
1/2" = 1'-0"

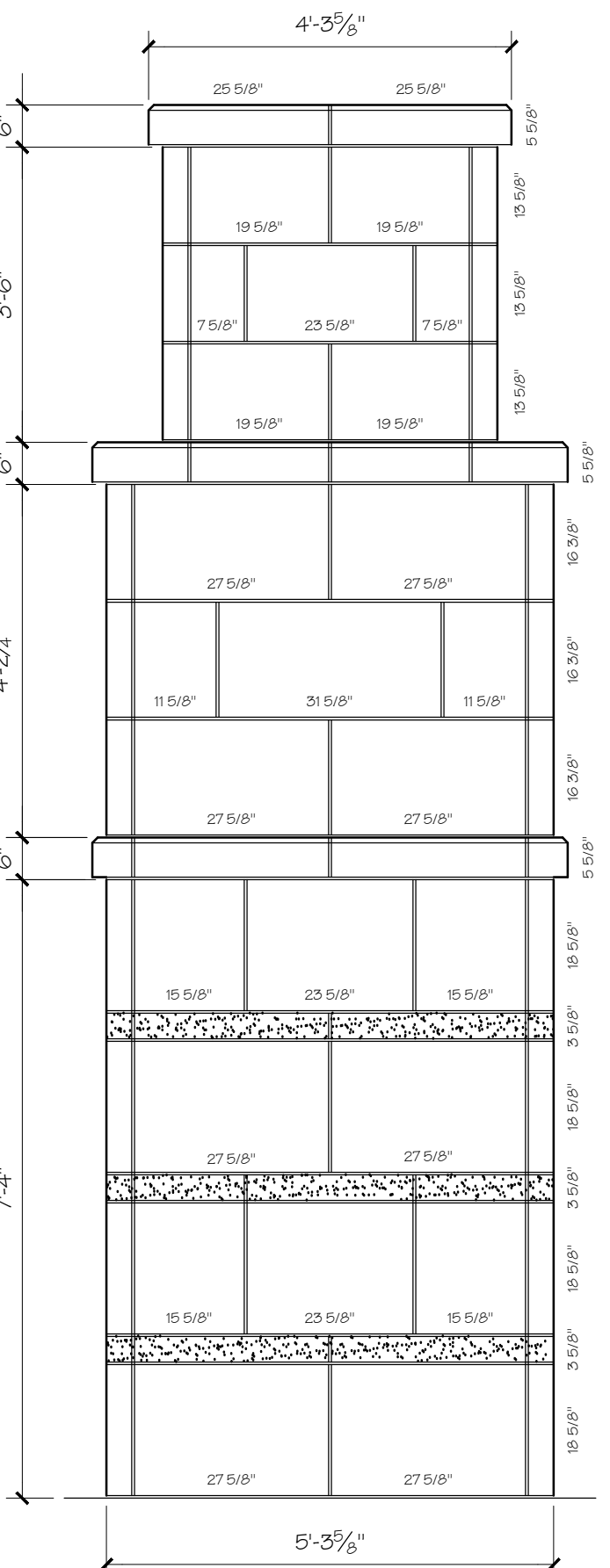

1 SIDE VIEW @ TOWER
1/2" = 1'-0"

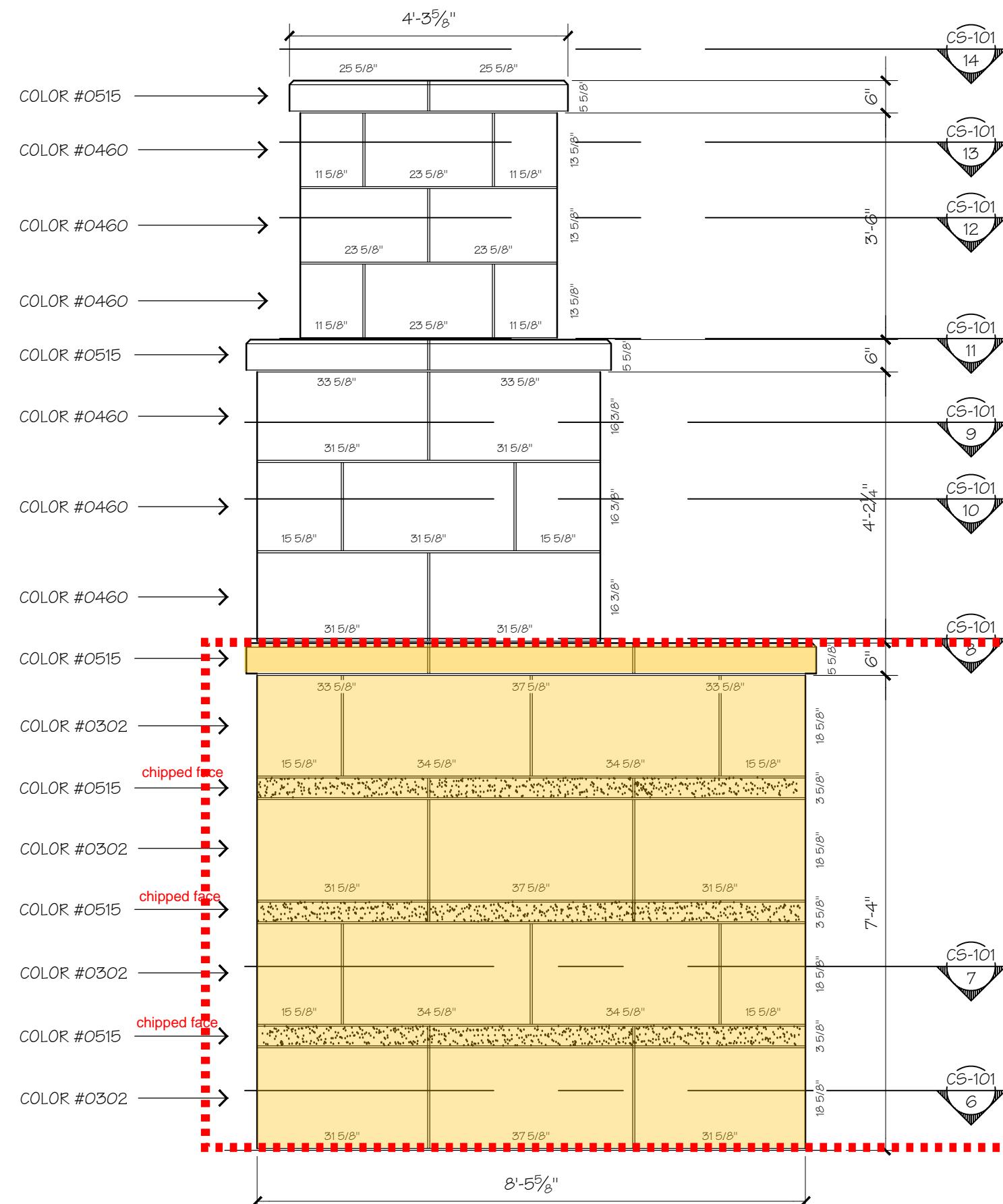

2 ELEVATION @ TOWER
1/2" = 1'-0"

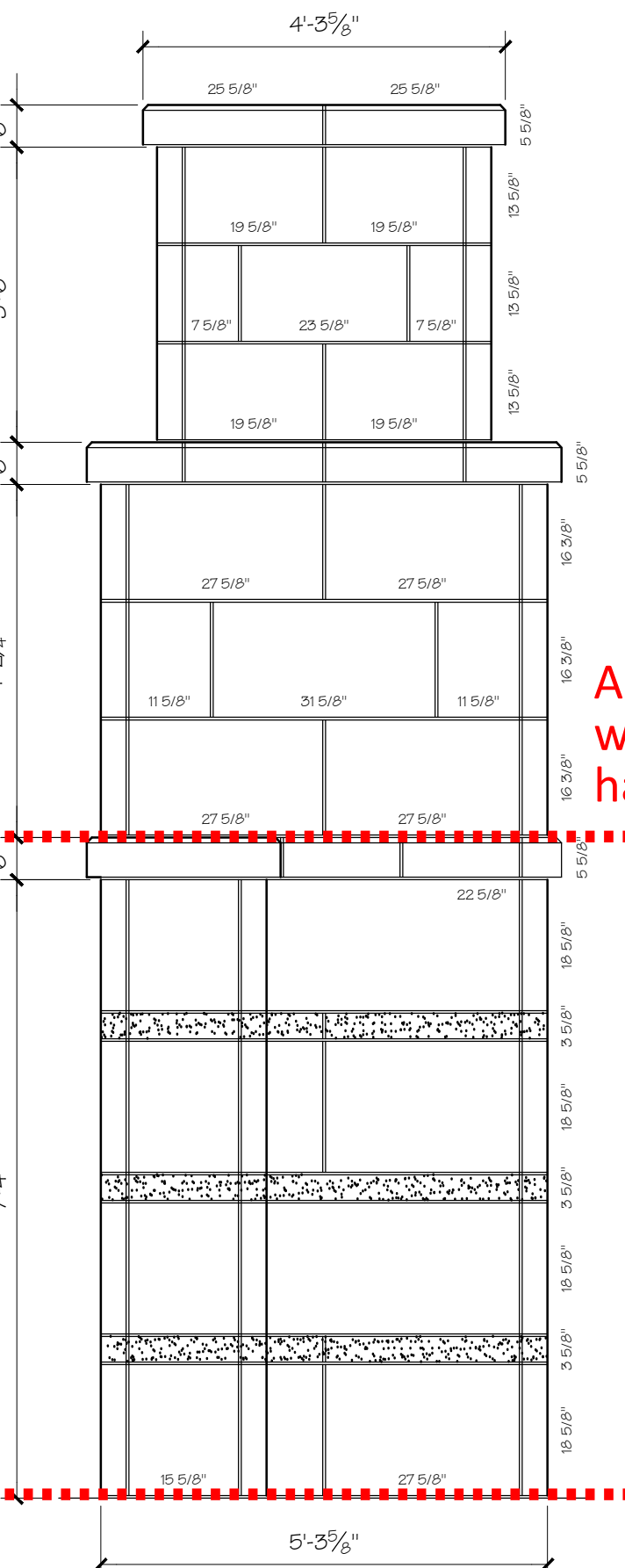

3 SIDE VIEW @ TOWER
1/2" = 1'-0"

All Cast Stone within this area to have anti-graffiti coating

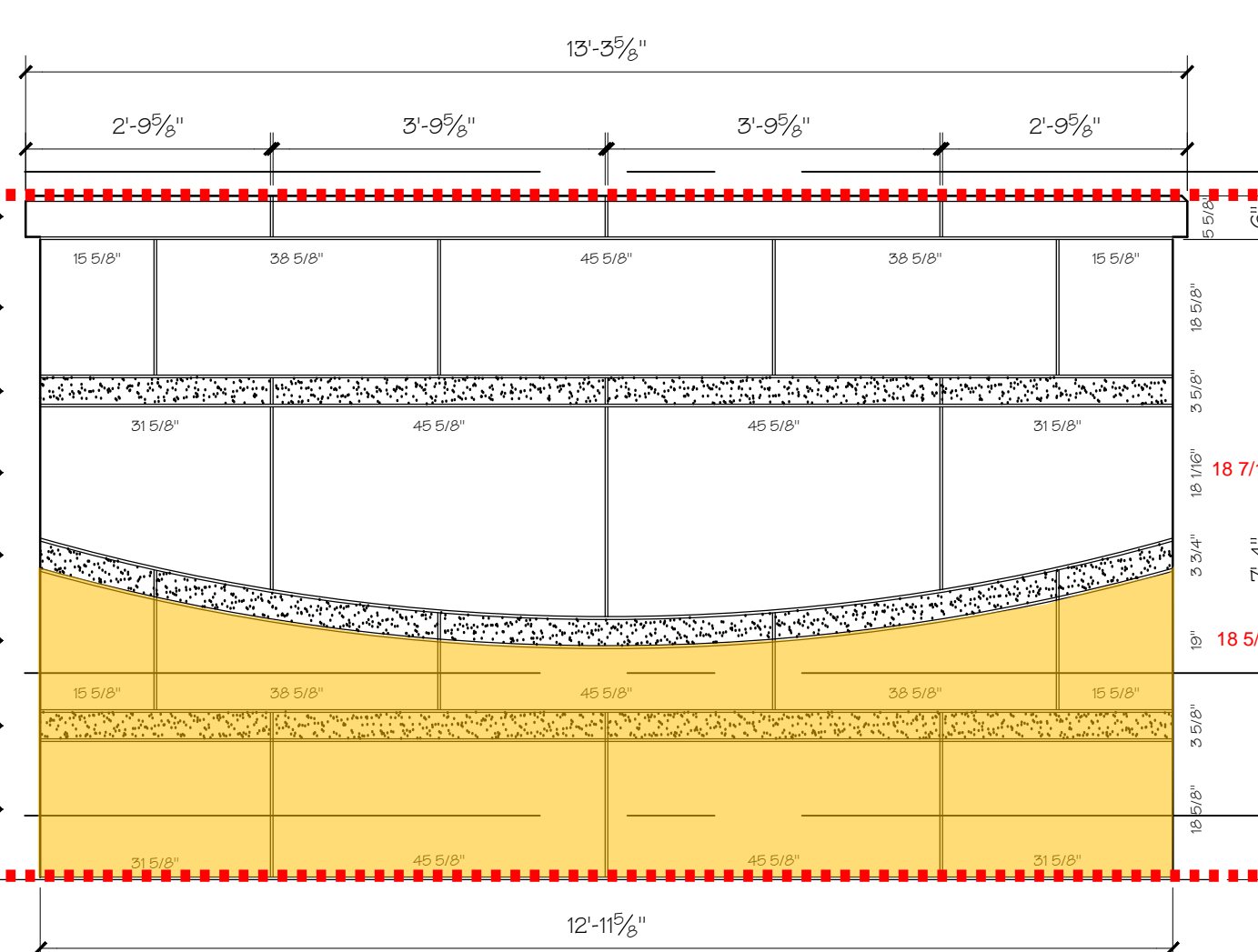

4 ELEVATION @ WALL
1/2" = 1'-0"

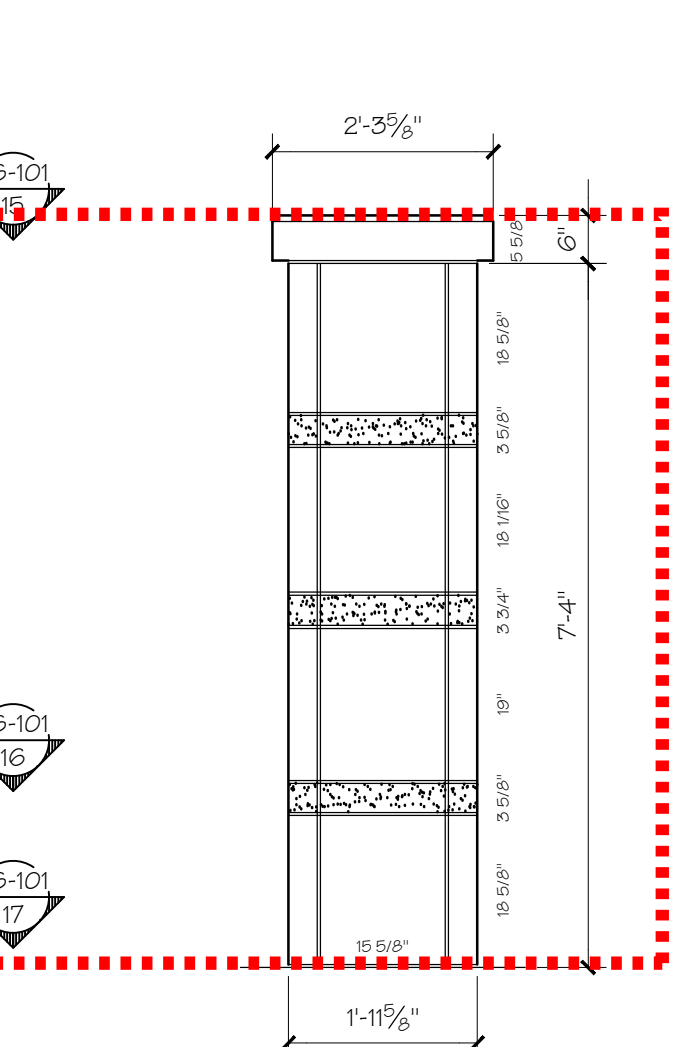

5 SIDE VIEW @ WALL
1/2" = 1'-0"

| | |
|--|-----------------------|
| DATE | 01-02-14 |
| | FOR REVIEW & APPROVAL |
| REV. # | 1.0 |
| SCALE: | AS NOTED |
| PROJECT #: | 8967 |
| DRAWN BY: | Michael Nguyen |
| DATE: | 01-02-14 |
| SITEWORKS | |
| ARCHITECTURAL CAST STONE | |
| 983 W. CANNON - HOUSTON, TEXAS 77037 | |
| PHONE - (281) 931-1000, FAX - (281) 931-1044 | |
| DEER PARK GATEWAY | |
| DEER PARK, TEXAS 77536 | |
| PROJECT NAME: | |
| SHEET NAME: TOWER WALL & DETAILS | |
| CAST STONE | |
| SHEET NUMBER | CS-101 |
| OF: | 2 |

APPROXIMATELY 20-25 PAVESTONE ARE
CHIPPED OR CRACKED. DAMAGE CAUSED
BY TRUCK TIRES



REPLACE CONCRETE
PAVERS FROM THIS
POINT FORWARD



DAMAGE TO CONCRETE PAVERS, SURFACE
CRACKS, CHIPS AND BASE FAILURE

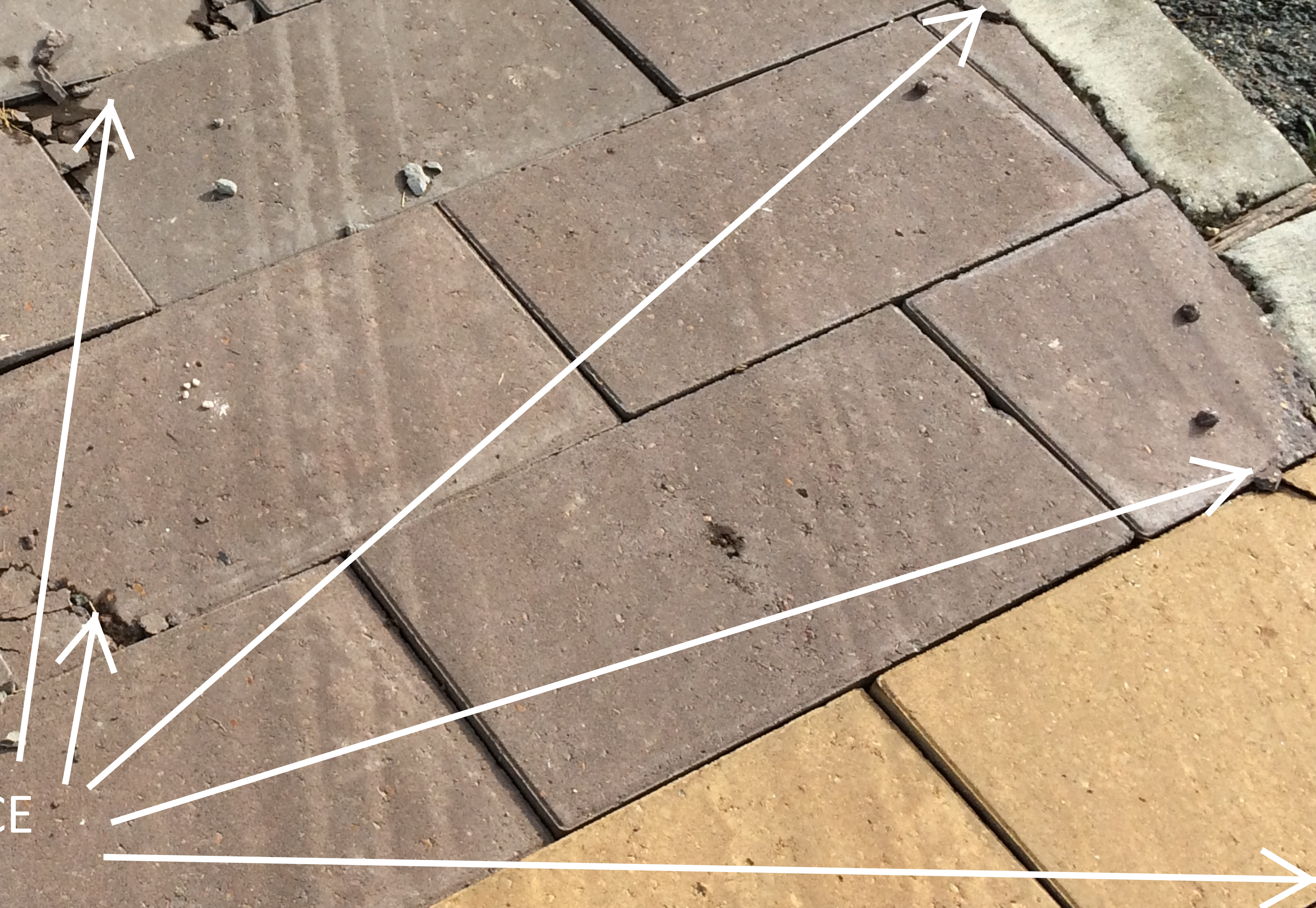

STAR MOUNTING ANCHORS RIPPED FROM WALL CAUSING DAMAGE TO SURROUNDING STONE AND GROUT JOINTS (MULTIPLE LOCATIONS)



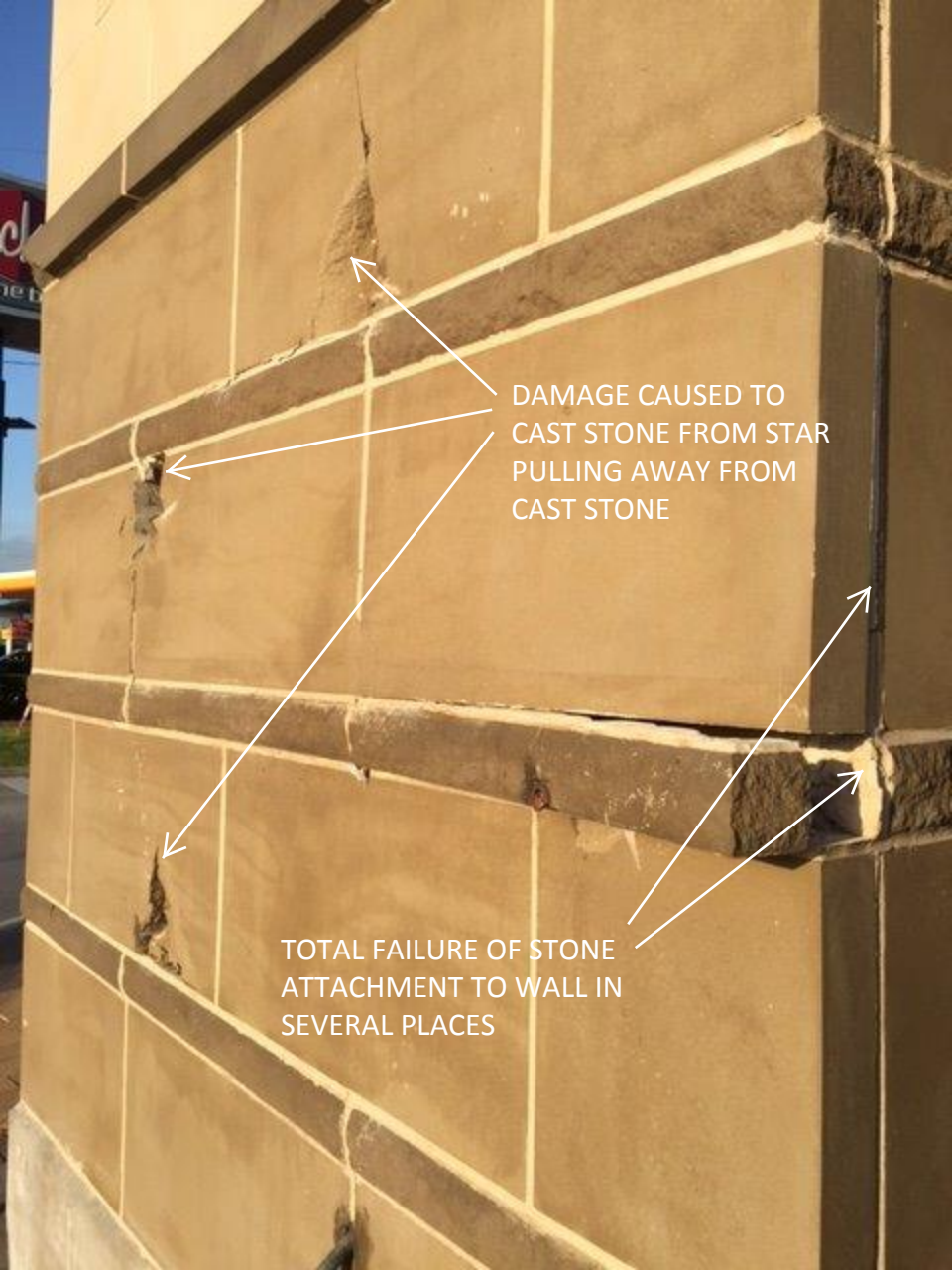

DAMAGE CAUSED TO
CAST STONE FROM STAR
PULLING AWAY FROM
CAST STONE

TOTAL FAILURE OF STONE
ATTACHMENT TO WALL IN
SEVERAL PLACES



DAMAGE TO CAST STONE
WATER TABLE/CAP



CAST STONE CAP
HAS MOVED AND
MORTAR HAS BEEN
COMPROMISED



SURFACE SCRAPE ON CAST
STONE - RECOMMEND
REPLACING ENTIRE COLOR OF
THIS STONE ON THIS
ELEVATION TO SO THAT
COLOR REMAINS EVEN.



STEEL STAR WAS
DAMAGED WHEN
DRAGGED BY TRUCK.
METAL EDGE HAS BEEN
DAMAGED. METAL
STUDS DEFOMED STEEL
WHEN RIPPED FROM
WALL. REQUIRES TOTAL
REPLACEMENT