

February 19, 2018

Attn: Deer Park City Council

Re: Specific Use Permit Request for the Lonsford (south) Tract, 1.32 Acres, East Blvd.

To Whom It May Concern:

We are requesting a Specific Use Permit for the southern Lonsford Tract (1.32 Acres) on the west side of East Blvd., adjacent to the proposed Vet. Clinic (to the north).

The proposed use will be **Assisted Living**.

See the included exhibits describing the intent of the improvements and the specific location.

If you have any questions regarding this, please feel free to contact me.

Respectfully Submitted,



Nolan Allen  
Penelope Land Investments, L.P.  
713-472-2400

# CITY OF DEER PARK

## Specific Use Permit



LN- 000288 -2018

PERMIT #: LN- 000288 -2018

PROJECT:

ISSUED DATE: February 20, 2018

EXPIRATION DATE: February 20, 2019

PROJECT ADDRESS: 4320 EAST BLVD

OWNER NAME: RI Chardale Properties Llc

CONTRACTOR:

ADDRESS: 103 S Y St

ADDRESS:

CITY: La Porte

CITY:

STATE: TX

STATE:

ZIP: 77571

ZIP:

PHONE:

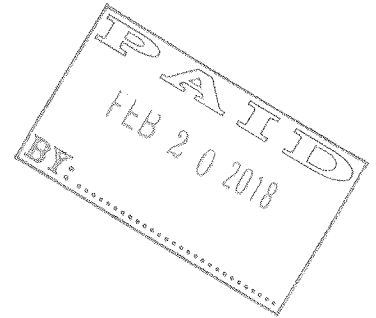

### PROJECT DETAILS

PROPOSED USE:

SQ FT:

0

DESCRIPTION: Specfic Use Permit For The Southern  
Lonsford Tract (1.32 Acres) On The  
West Side Of East Blvd

VALUATION:

\$ 0.00

### PERMIT FEES

TOTAL FEES: \$ 1,000.00

PAID: \$ 1,000.00

BALANCE: \$ 0.00

**ALL PERMITS MUST BE POSTED ON THE JOBSITE AND VISIBLE FROM THE STREET**

### NOTICE

THIS PERMIT BECOMES NULL AND VOID IF WORK OR CONSTRUCTION AUTHORIZED IS NOT COMMENCED WITHIN 6 MONTHS, OR IF CONSTRUCTION OR WORK IS SUSPENDED OR ABANDONED FOR A PERIOD OF 1 YEAR AT ANY TIME AFTER WORK IS STARTED. ALL PERMITS ARE SUBJECT TO THE FOLLOWING:

- ALL WORK MUST COMPLY WITH THE BUILDING , ELECTRICAL, PLUMBING, AND MECHANICAL CODES ADOPTED BY THE CITY OF DEER PARK AT THE TIME THE PERMIT IS ISSUED .
- IT IS THE RESPONSIBILITY OF THE OWNER/CONTRACTOR TO COMPLY WITH ALL STATE & FEDERAL DISABILITY REQUIREMENTS.
- ENCROACHMENTS OF EASEMENTS AND RIGHT-OF-WAYS ARE NOT ALLOWED .

I HEREBY CERTIFY THAT I HAVE READ AND EXAMINED THIS DOCUMENT AND KNOW THE SAME TO BE TRUE AND CORRECT . ALL PROVISIONS OF LAWS AND ORDINANCES GOVERNING THIS TYPE OF WORK WILL BE COMPLIED WITH WHETHER SPECIFIED HEREIN OR NOT . GRANTING OF A PERMIT DOES NOT PRESUME TO GIVE AUTHORITY TO VIOLATE OR CANCEL THE PROVISION OF ANY OTHER STATE OR LOCAL LAW REGULATING CONSTRUCTION OR THE PERFORMANCE OF CONSTRUCTION .

SIGNATURE OF CONTRACTOR OR AUTHORIZED AGENT

DATE

APPROVED BY

DATE

**TO SCHEDULE NEXT DAY INSPECTIONS CALL BY 4PM 281-478-7270**  
**ALL REINSPECTIONS ARE SUBJECT TO A \$45.00 REINSPECTION FEE**

You can request a morning or afternoon inspection and we will do our best to accommodate you but there are no guarantees, it will depend on the volume of inspections scheduled that day .

710 E San Augustine Deer Park, TX 77536 Fax 281-478-0394  
[www.deerparktx.gov/publicworks](http://www.deerparktx.gov/publicworks)

1.0331 ACRE TRACT FOR PROPOSED VET. CLINIC

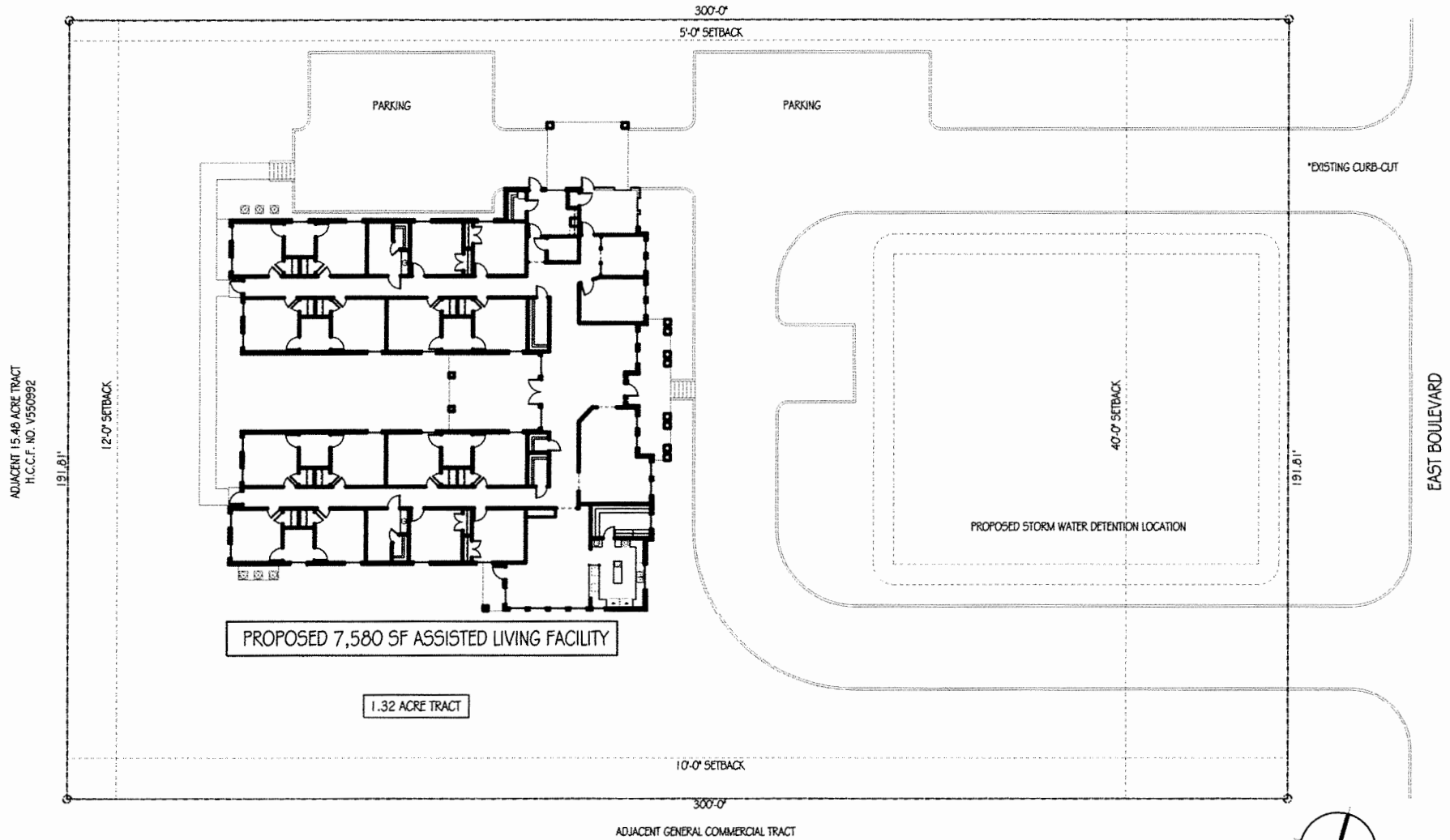

SCHEMATIC SITE PLAN  
N.T.S.  
02-20-18



MARTINEZ CESAR & REBECA  
6806 OLYMPIA DR  
PASADENA TX, 77505-3361

LA PORTE ISD  
604 W FAIRMONT PKWY  
LA PORTE TX, 77571-6215

PENELOPE LAND INVESTMENT  
LP  
PO BOX 7725  
PASADENA TX, 77508-7725

STOCKARD REALTY  
PARTNERSHIP LTD  
2001 KIRBY DR STE 510  
HOUSTON TX, 77019-6046

DELUXE INCORPORATED %  
ELTON TILLERY  
3201 THREE SISTER CIR  
PEARLAND TX, 77581-4577

DELUXE INCORPORATED %  
ELTON TILLERY  
3201 THREE SISTER CIR  
PEARLAND TX, 77581-4577

HARRIS COUNTY FLOOD  
CONTROL DISTRICT  
9900 NORTHWEST FWY  
HOUSTON TX, 77092-8601

DIVYA PROPERTIES LP  
9407 SUNDOWN DR  
PEARLAND TX, 77584-2885

LA PORTE ISD  
604 W FAIRMONT PKWY  
LA PORTE TX, 77571-6215

COASTAL INDUSTRIAL WATER  
AUTHORITY  
1200 SMITH ST STE 2260  
HOUSTON TX, 77002-4500

R L CHARDALE PROPERTIES  
LLC  
103 S Y ST  
LA PORTE TX, 77571-6656

WAL-MART REAL ESTATE  
BUSINESS TRUST MS 0555  
PO BOX 8050  
BENTONVILLE AR, 72712-8055

NEC SPENCER HIGHWAY &  
EAST BOULEVARD  
3102 MAPLE AVE STE 500  
DALLAS TX, 75201-1262

MAIL NOTICE TO:  
ARCON

814 HALL AVE

SEABROOK, TX

Ngan  
Allen  
notice 77586