

County: Harris
Project: Vopak Moda Houston
M.S.G. No.: 201046
Job Number: 3799-ALTA

TRACT 6 PARCEL 2
FIELD NOTES FOR A 0.0135 ACRE TRACT

Being a tract of land containing 0.0135 acre (589 square feet), located in the George Ross Survey, Abstract Number (No.) 646, in Harris County, Texas; Said 0.0135 acre tract being all of a called 0.0135 acre tract recorded in the name of Vopak Moda Houston LLC in Harris County Clerk's File Number (H.C.C.F.) No. RP-2019-50226; Said 0.0135 acre tract being more particularly described by metes and bounds as follows (all bearings are based on the Texas Coordinate System of 1983 (NAD83), South Central Zone, per GPS observations):

BEGINNING at a 5/8-inch iron rod with a cap stamped "Miller Survey Group" (MSG) set on the northerly line of a called 4.994 acre tract recorded in the name of Houston Lighting & Power Company in Volume (Vol.) 2379, Page (Pg.) 374, Harris County Deed Records, marking the southeast corner of said 0.0135 acre tract and the herein described tract, from which a 5/8-inch iron rod with a cap stamped "MSG" set at the northeast corner of a called 0.1341 acre tract recorded in the name of Vopak Moda Houston LLC in Harris H.C.C.F. No. RP-2019-50226, bears South 02 degrees 40 minutes 00 seconds East, a distance of 122.82 feet;

Thence, through and across the residue of a called 378.295 acre tract recorded in the name of Rohm and Hass Texas Incorporated in H.C.C.F. No. D560866 and along the southerly and westerly lines of said 0.0135 acre tract and the herein described tract, the following two (2) courses:

1. South 87 degrees 33 minutes 39 seconds West, a distance of 30.00 feet to a 5/8-inch iron rod with a cap stamped "MSG" set at the southwest corner of said 0.0135 acre tract and the herein described tract;
2. North 02 degrees 31 minutes 04 seconds West, a distance of 19.64 feet to a 5/8-inch iron rod with a cap stamped "MSG" set on the southerly line of a called 2.931 acre tract recorded in the name of Harris County Houston Ship Channel Navigation District in Vol. 2679, Pg. 495, H.C.D.R., marking the northwest corner of said 0.0135 acre tract and the herein described tract;

Thence, through and across said 378.295 acre and along the line common to the southerly line of said 2.931 acre tract and the northerly line of said 0.0135 acre tract and the herein described tract, North 87 degrees 32 minutes 40 seconds East, a distance of 30.00 feet to a 5/8-inch iron rod with a cap stamped "MSG" set at the northeast corner of said 0.0135 acre tract and the herein described tract;

Thence, through and across said 378.295 acre tract and along the easterly line of said 0.0135 acre tract and the herein described tract, South 02 degrees 31 minutes 04 seconds East, a distance of 19.65 feet to the **POINT OF BEGINNING** and containing 0.0135 acre (589 square feet) of land.

This description was prepared in conjunction with and accompanies an ALTA/NSPS Land Title Survey prepared by Miller Survey Group.

47. tf2 ~~£~~ uc

Texas Registration No. 5047

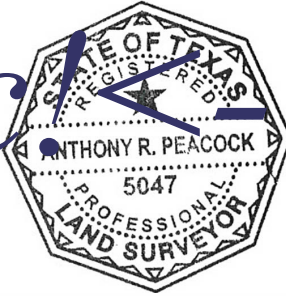

Miller Survey Group
www.millersurvey.com
Texas Firm Reg. 10047100
Ph: (713) 413-1900
M&B No. 201046
Dwg. No. 3799-ALTA
Date: January 23, 2020